

FREEHOLD



House - Detached (EPC Rating:)

2, LIMEKILNS MILLCROFT ROAD, CUMBERNAULD, GLASGOW, G67 4AG

Offers in the region of
£700,000

FEATURES

- 5 spacious bedrooms
- Open-plan kitchen
- Off-street parking
- Country Living
- 4 modern bathrooms
- Private garden
- Detached house
- Close to local schools



**SWEET
HOME**



5 Bedroom House - Detached located in Glasgow

Caroline Morrison of Sweet Home Scotland is proud to bring to the market this exquisite detached house, offering a unique opportunity for those seeking a self-build property of exceptional quality. Nestled in a tranquil rural setting on Millcroft Road, Cumbernauld, Glasgow, surrounded by picturesque fields and a select few new build homes, this residence is designed to the highest standards, providing both comfort and style.

Upon entering, you are welcomed by a spacious ground-floor hall that leads to a convenient cloakroom. The heart of the home is the open-plan kitchen and dining area, featuring a large island and integrated appliances—perfect for both family gatherings and entertaining guests. Additionally, the ground floor includes a double bedroom with an adjoining sitting room, ideal for elderly parents or teenagers. A formal lounge and a well-appointed shower room complete the ground floor.

The upper floor boasts four generously sized double bedrooms, ensuring ample space for family or guests. Two of these bedrooms benefit from en-suite facilities, providing a touch of luxury and privacy. The two middle bedrooms feature an adjoining balcony, offering a delightful outdoor space to enjoy the surrounding views. Completing the upper floor is a family bathroom, thoughtfully designed for convenience.

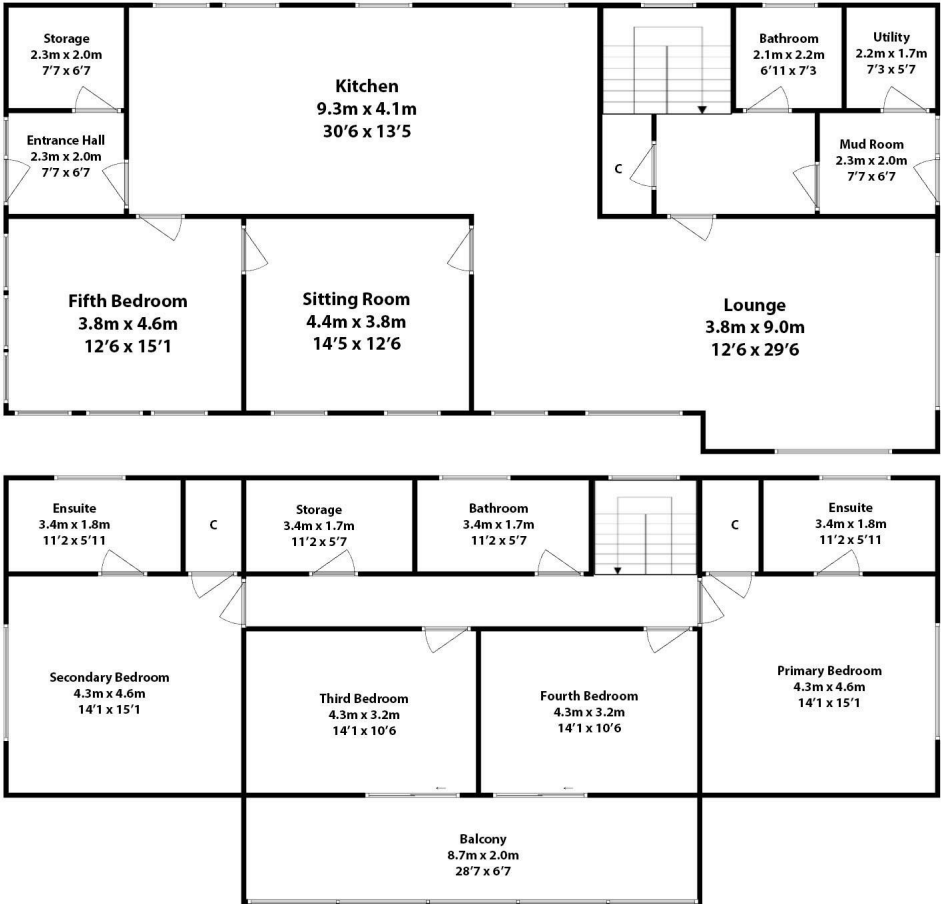

Call us on

07717504350

sales@sweet-home.co.uk

<https://sweet-home.co.uk/>

Council Tax Band

G

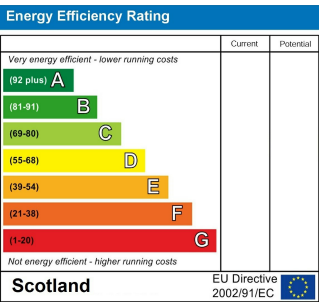

Agents Note: Whilst every care has been taken to prepare these particulars, they are for guidance purposes only. All measurements are approximate and are for general guidance purposes only and whilst every care has been taken to ensure their accuracy, they should not be relied upon and potential buyers are advised to recheck the measurements.

